



UTV INTERNATIONAL

KODIAK K6 CRAWLER CARRIER

SPECIFICATIONS



<p><u>DIMENSIONS / WEIGHT</u></p> <p>Overall length 241" with plow and dump box Overall width 101" with plow Overall height 111" Ground clearance 18" Weight 14,000 lbs Payload 12,000 lbs GVWR 28,000 lbs</p> <p><u>PERFORMANCE</u></p> <p>Maximum speed 9 mph loaded Inside turning radius 0 ft Ground pressure 2.49 PSI unloaded (6" penetration) 4.36 PSI loaded Maximum gradeability Static test when loaded - Uphill 35° (70%) continuous - Side-hill 15° (27%) Normal driving range 12 hours</p> <p><u>ENGINE</u></p> <p>Make Deutz AG Tier 4 Model TCD 3.6 L4, 4 cylinder Turbo charged diesel Horsepower 134 HP at 2,300 RPM Torque 369 ft lbs at 1,600 RPM Displacement 3.6 liters Fuel capacity 50 gals DEF tank 2.6 gals Cooling system 4.0 gals</p>	<p><u>FRAME / SUSPENSION</u></p> <p>Type Corten Welded Tub</p> <p>Suspension system:</p> <ul style="list-style-type: none"> ➤ Patented walking beam with double twin rocker bogey wheel suspension ➤ 2 independent idler wheels with oil bath hubs and steel face seals ➤ 2 rear drive sprockets ➤ 16 steel wheels, 12" dia <p><u>POWER TRAIN FOR HYDROSTATIC DRIVE</u></p> <p>Transmission Hydrostatic, 2-speed Service Brakes Positive deceleration through the hydrostatic transmission Parking brakes Multi-Disc, spring applied & pressure released</p> <p><u>ELECTRICAL</u></p> <p>Voltage 12 V Battery Capacity 850 CCA Alternator Capacity 120 Amps Ground Negative</p> <p><u>TRACKS</u></p> <p>One piece 24" rubber tracks with steel reinforcements</p> <p><u>STEERING</u></p> <p>Independent dual joysticks with cable control for each track</p>
--	---

STANDARD FEATURES

- | | |
|--|--|
| <ul style="list-style-type: none"> 1-Man open cab ROPS certified Roll Over Protection Structure ISO 3471:2008 Vinyl seat with mechanical suspension 2-point seat belt Full instrumentation, illuminated panel gauge High powered LED lights: 2 front & 1 rear on cab, 1 strobe on top Muffler, engine block heater & glow plugs | <ul style="list-style-type: none"> Electronic engine protection system Primary fuel filter with water separator Fire extinguisher Backup alarm and horn Driver's side deck ladder 1 set of operations, parts & service manuals Standard one-year warranty |
|--|--|

*Specifications subject to change without notice.

KODIAK K6 CRAWLER CARRIER OPTIONS & ACCESSORIES

Cab Options

Driver's wire mesh screen (open cab)
Driver's left side wire mesh door and side wall (open cab)
Cab mount front- brush guard for 1-man cab (open or closed)
1 Man Closed Cab ROPS certified includes: Aluminum escape hatch Sliding left & right side window Cab heater & circulation fan Front windshield on/off wiper & windshield washer Door with dual locking system



KODIAK K6 CRAWLER CARRIER OPTIONS & ACCESSORIES Cont'd

Cab Options continued

Cab mount front brush guard for 2-man cab
Two Man Open Cab with Roll Over Protection System includes: 2 vinyl mechanical suspension seats with slider 2 point seat belts 1 rearview mirror
Two Man Closed Cab with Roll Over Protection System includes: 2 vinyl mechanical suspension seats with slider 2 point seat belts 1 rearview mirror
Steering wheel system (mechanical steering with foot pedals for forward and reverse)
Steel escape hatch for open or closed cab (adds FOPS certification)
Front windshield intermittent wiper (closed cab)
Street side and / or curb side rear view mirror
Street side rear view mirror with electric heating
Sun visor
Driver's 3 point seat belt
Back up camera with heated lens and 7" in-cab waterproof display
Premium cab sound and heat Insulation
DC Comfort air conditioning 6,000 BTU/hr, 12V

Engine & Cold Weather Options

Spark arrestor
Complete Cold Start - Includes: (can be purchased individually) Oil Heater with Cable & Plug Second Battery Cold Weather Oil for Engine & Hydraulic System (All Season)
Extreme cold package for operations to -40 deg C/-40 deg F, 120v hydraulic oil heater, 120v battery heaters, 12vdc heated fuel filter, coolant heater for hydraulic oil, coolant heater for fuel tank, auxiliary cab heater
12v engine coolant heater, 17,000 Btu with 7 day programmable timer
120v battery heater(s)
12vdc heated fuel filter
Coolant heater for hydraulic oil
Coolant heater for fuel tank
Optional Engine: Deutz EG TCD 3.6 L4 Tier 4, 4 cylinder diesel, 3.6L displacement, 140 HP horsepower at 2,300 RPM, 405 ft/lbs torque at 1,600 RPM
Optional Engine: JCB Power Systems Ecomax 448 TA4 Tier 4, 4 cylinder diesel, 4.8L displacement, 173 HP horsepower at 2,050 RPM, 492 ft/lbs torque at 1,500 RPM

Vehicle Options / Features

2 way medium duty front plow for pushing loose fill
Front bumper & brush guard, tapered at edges to push brush away
Electric winch, 12,000 lbs

KODIAK K6 CRAWLER CARRIER OPTIONS & ACCESSORIES Cont'd

Vehicle Options / Features continued

Electric winch, 15,000 lb
Electric winch, 16,500 lbs
Electric winch, 17,500 lbs
Hydraulic winch, 18,000 lbs
Hydraulic winch, 20,000 lbs
5 cubic yard dump box
Flatbed deck 96"L x 96"W
Flatbed deck 110"L x 93"W
Flatbed deck 120"L x 96"W
Rear auxilliary 2-way low flow hydraulics, 0-24 GPM, 2,500 psi
Rear auxilliary 2-way low flow hydraulics, 25 GPM, 3,000 psi
Crane, 18 tm, behind the cab, lift: 3,300 lbs at 4' 3", 1,000 lbs at 13' 5", manual control, installed
Crane, 18 tm, behind the cab, lift: 3,300 lbs at 4' 3", 1,000 lbs at 13' 5", remote control, installed
1/2 subframe (open at the front end) with radial rear outriggers attached (suitable for a track drill, digger derrick or aerial mounting)
1/2 subframe (open at the front end) with straight down rear outriggers attached (suitable for a track drill mounting)
Subframe for crane mounting
DOT road lighting
Pintle hook with rear receptacle
Maintenance kit (high performance filter set for first 100 hour maintenance return & supercharge filters)
Additional set of operations, parts & service manuals
One days on site Operations and Maintenance training
Recommended spare parts for remote operations
Other options available upon request

KODIAK K6 CRAWLER CARRIER ONE MAN CAB DIMENSIONS

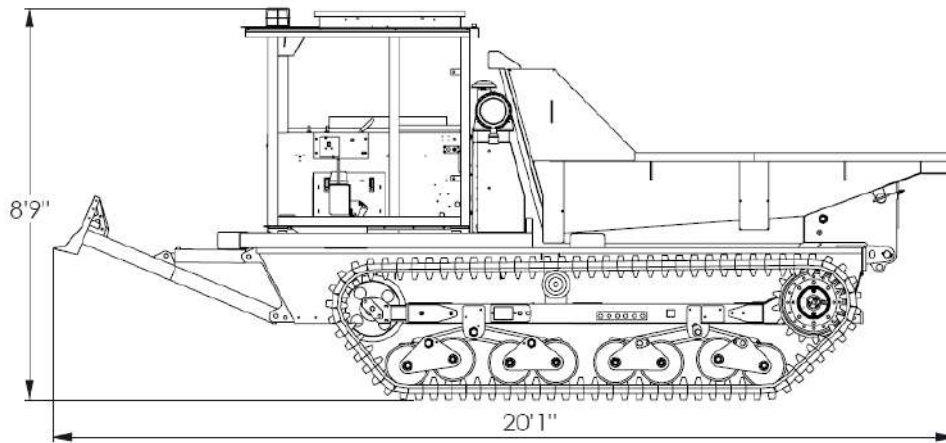
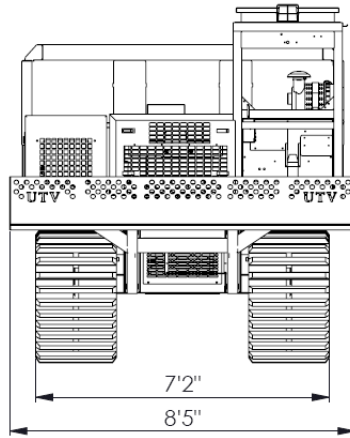

KODIAK K6 CRAWLER CARRIER DIMENSIONS

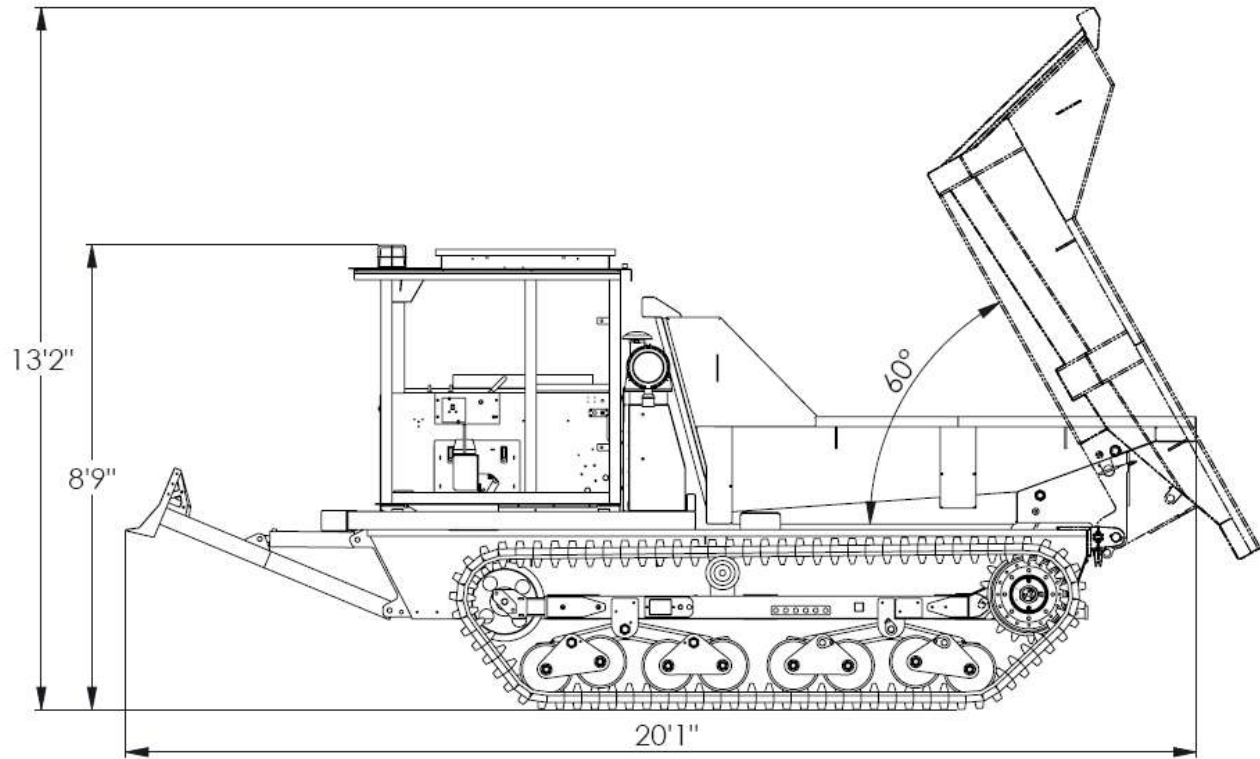

KODIAK K6 CRAWLER CARRIER TWO MAN CAB DIMENSIONS FLAT BED DECK

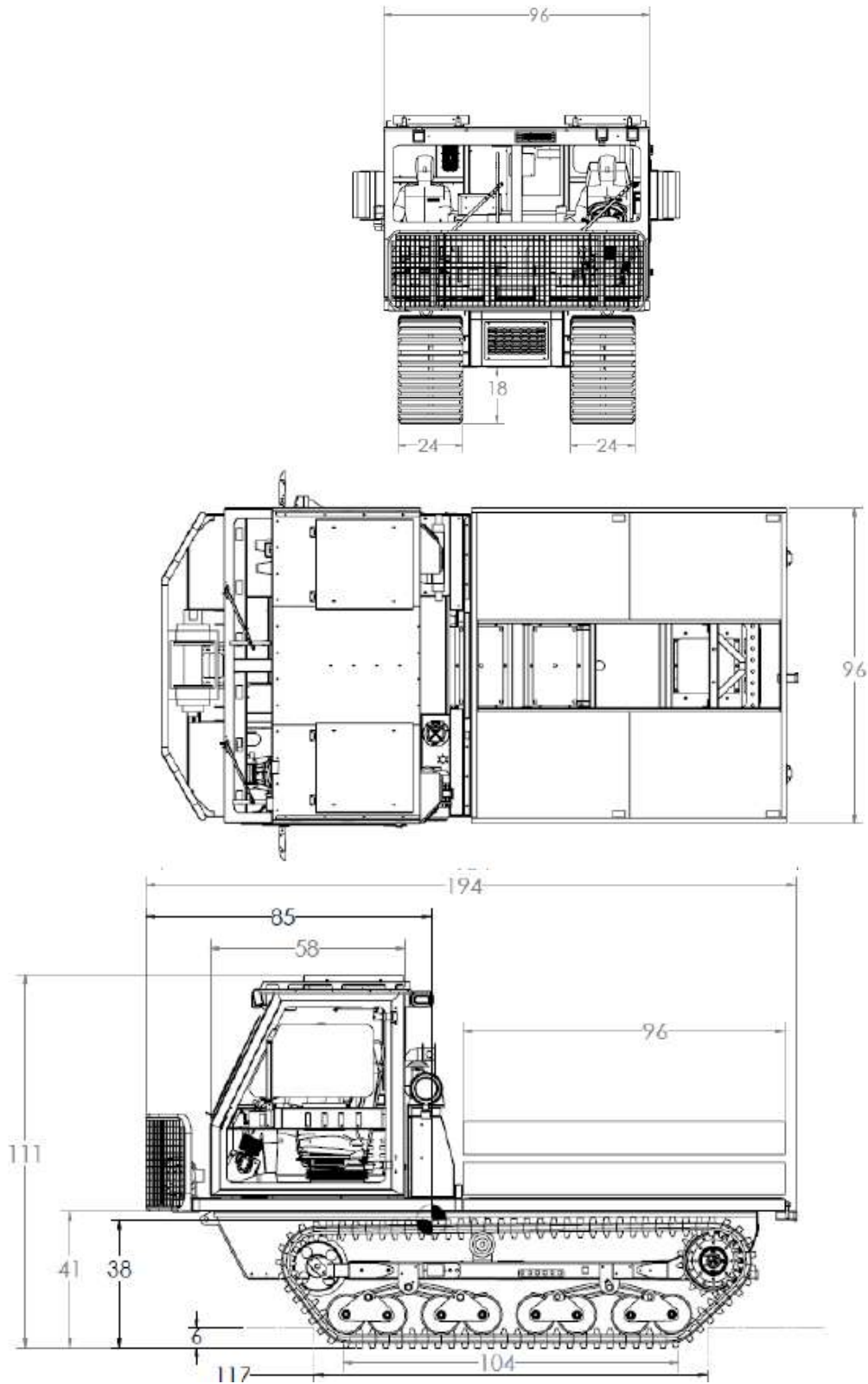

KODIAK K6 CRAWLER CARRIER TWO MAN CAB DIMENSIONS DUMP BOX

